

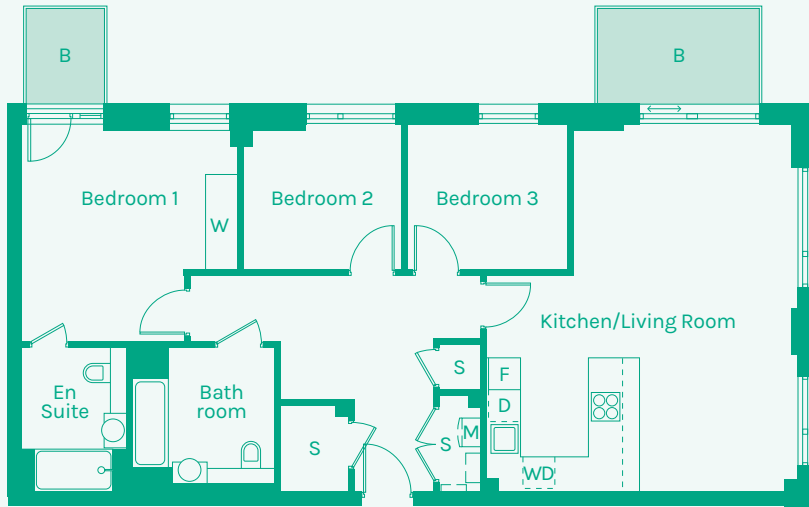

NEW GARDEN QUARTER

STRATFORD E15



TYPE 18

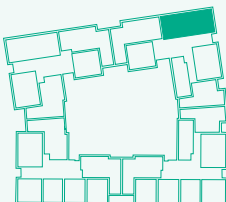

Room	Metric	Imperial	Block	Floor	Plot
Kitchen/Living Room	5.88 x 6.94m	19'4" x 22'9"	F	1	163
Hall	5.47 x 2.31m	17'11" x 7'7"			
Bathroom	2.69 x 2.60m	8'10" x 8'6"			
Bedroom 1	4.05 x 4.07m	13'3" x 13'4"			
Bedroom 2	3.00 x 2.74m	9'10" x 9'0"			
Bedroom 3	3.04 x 2.74m	10'0" x 9'0"			
Ensuite	1.94 x 2.73m	6'4" x 9'0"			
GIA	99.40m²	1070 sq ft			

B // Balcony

F // Fridge Freezer

S // Storage

W // Wardrobe

D // Dishwasher

M // Mechanical Extract Ventilation Unit

T // Terrace

WD // Washer / Dryer



These plans are to be used as a guide only to the apartment types available.