



NEW GARDEN QUARTER

STRATFORD E15



TYPE 27

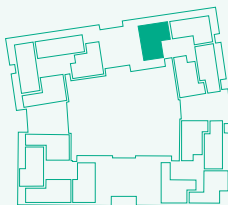

Room	Metric	Imperial	Block	Floor	Plot
Kitchen/Living Room	3.93 x 7.04m	12'11" x 23'1"	F	6	196
Hall	1.80 x 5.22m	5'11" x 17'2"			
Bathroom	1.99 x 2.14m	6'6" x 7'0"			
Bedroom 1	4.85 x 2.94m	15'11" x 9'8"			
Bedroom 2	3.92 x 3.36m	12'10" x 11'0"			
Ensuite	1.43 x 2.15m	4'8" x 7'1"			
GIA	77.50m²	834 sq ft			

- B // Balcony
- D // Dishwasher
- F // Fridge Freezer
- M // Mechanical Extract Ventilation Unit
- S // Storage
- T // Terrace**
- W // Wardrobe
- WD // Washer / Dryer



These plans are to be used as a guide only to the apartment types available.