

# Parkside

## Three bedroom apartment

GUTHRUM COURT

3

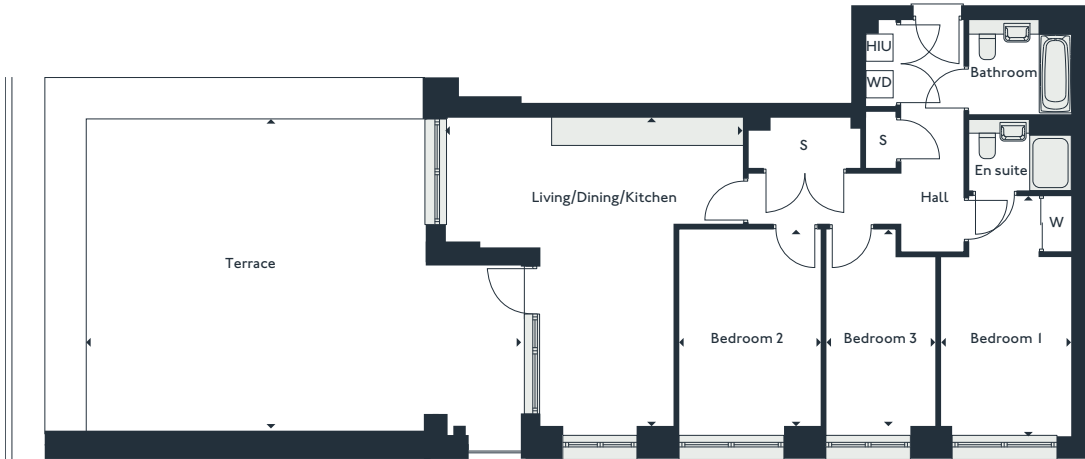

### Second floor

Living/Dining/Kitchen	6.4m x 6.6m	20'11" x 21'8"
Bedroom 1	2.8m x 5.2m	9'2" x 16'11"
Bedroom 2	3.1m x 4.2m	10'0" x 13'10"
Bedroom 3	2.4m x 4.2m	7'9" x 13'10"
Terrace	9.3m x 6.7m	30'7" x 21'10"

**Gross internal area 91.5 m<sup>2</sup> 985 sqft**

S - Storage  
 W - Wardrobe  
 WD - Washer Dryer  
 HIU - Heat Interface Unit

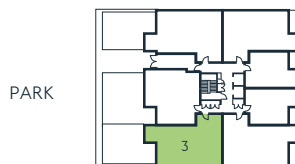

Second floor

**ROYAL  
 ALBERT  
 WHARF**

THE ROYAL DOCKS

[www.royalalbertwharf.com](http://www.royalalbertwharf.com)

\*Handed to floorplan shown. Layouts shown here are for approximate measurements only. They are not necessarily shown to scale. Exact layout and sizes of properties may vary. Please speak to a Sales Advisor for exact details.