

# 12 BLOSSOM HOUSE, 5 RESERVOIR WAY

**1  
BED**

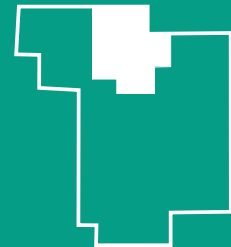
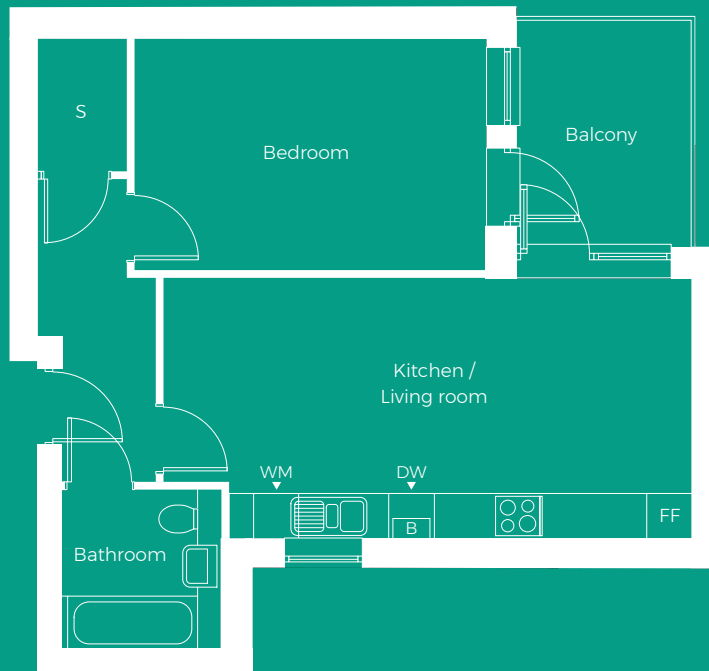

2ND FLOOR

	Imperial	Metric
Kitchen / Living room	22'10" x 11'3"	6.96m x 3.43m
Bedroom	15'3" x 10'0"	4.64m x 3.05m
Bathroom	6'11" x 6'11"	2.10m x 2.10m
Gross Internal Area	544sqft	50.5sqm
Balcony	9'8" x 7'5"	2.95m x 2.25m

- FF - **Fridge Freezer**
- WM - **Washer/dryer**
- DW - **Dishwasher**
- S - **Storage**
- W - **Wardrobe**
- B - **Boiler**