

# B1-L08-05

LEVEL 8

2 bedroom apartment

BLOCK A1



HEYBOURNE  
PARK

NW9

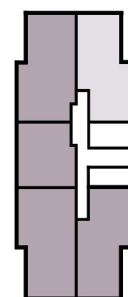

## Kitchen/Living/Dining

6.79m x 5.14m

22'3" x 16'10"

## Terrace Zone 1

6.88m x 3.58m

22'7" x 11'9"

## Bedroom 1

3.69m x 3.45m

12'1" x 11'4"

## Terrace Zone 2

6.08m x 1.22m

19'11" x 4'0"

## Bedroom 2

3.69m x 3.38m

12'1" x 11'1"

## Gross Internal Area

73.57 sq m

791.90 sq ft

### Key:

**DW** – Dishwasher **FF** – Fridge Freezer **FST** – Free-standing Table **HIU** – Heat Interface Unit  
**MVHR** – Mechanical Ventilation Heat Recovery system **ST** – Storage **TU/O** – Tall Unit with integrated Oven  
**W** – Built-in Wardrobe **WD** – Washer Dryer

The floorplans depict a typical layout of this apartment type. For exact apartment specification, details of external and internal finishes, dimensions and floorplan differences, consult your Sales Executive. Any areas, measurements or distances quoted are approximate only and should not be used when ordering floor coverings or furnishings. Floorplans are not shown to scale.

